

DATASHEET

COMPARTMENT FLOOR WITH CEMENT SCREED

GD18.02

VISIBLE CEILING

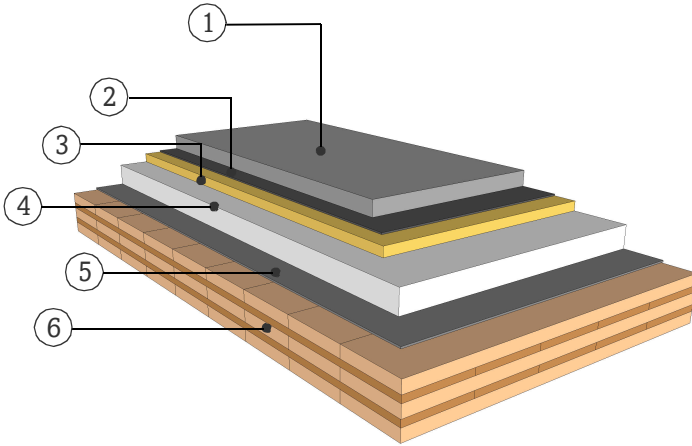

FIRE RESISTANCE

Pre-dimensioning one-sided fire attack

R*EI 30 > 3s 80 TL

R*EI 60 > 5s 120 TL

R*EI 90 > 5s 150 TL

*For residual load capacity or alternative design see <https://www.klhdesigner.at/>

SOUND INSULATION

R_w (C;C_{tr}) 58 (0;-3) [dB]

L_{n,w} (C_i) 47 (0) [dB]

<https://www.klh.at/online-bauteilkatalog/>

THERMAL PROTECTION

U 0,38 [W/m²K]

m_{w,B,A} 35/106 [kg/m²]

MATERIAL

PROPERTIES

	[mm]		λ [W/mK]	μ min-max [-]	ρ [kg/m³]	c [kJ/kgK]	
①	60.0	Cement screed	1.4	50	2200	1.1	A1
②		Separating layer					
③	30.0	Impact sound insulation s'≤ 10 MN/m³	0.032	1	110	0.84	A1
④	80.0	Gravel fill bonded	0.9	10	1450-1600	1	A1
⑤	5.0	Acoustic sheet s'≤ 115 MN/m³	0.045	20000	1400	1	E
⑥	160.0	TL, KLH solid timber slab	0.12	50 - 300	470	1.6	D

Thickness 335,0 [mm]

Mass per squaremeter ca. 335 [kg/m²]

Test report sound: HFA 2440/2017-BB
Calculation of the physical values by the
KLH Massivholz GmbH, without warranty