

DATASHEET

COMPARTMENT FLOOR WITH CEMENT SCREED

GD14.08

SUSPENDED CEILING ON RESILIENT CLIPS

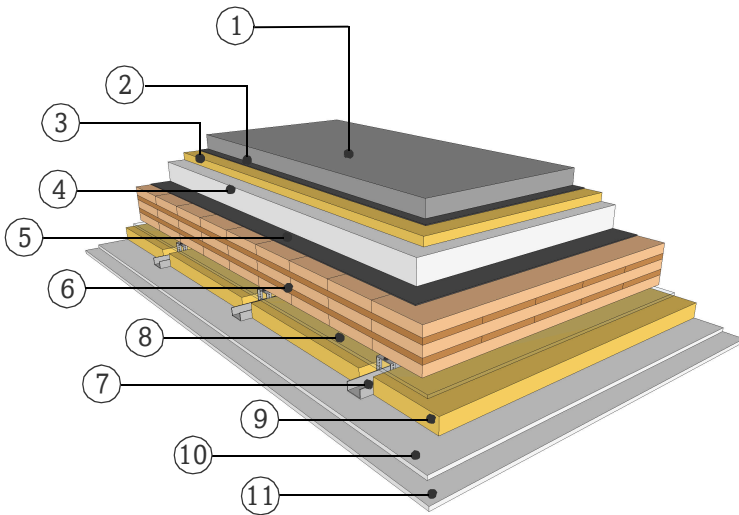

FIRE RESISTANCE

Pre-dimensioning one-sided fire attack

R*EI 30 > 3s 80 TL

R*EI 60 > 5s 120 TL

R*EI 90 > 5s 150 TL

*For residual load capacity or alternative design see <https://www.klhdesigner.at/>

SOUND INSULATION

R_w (C;C_{tr}) 74 (-3;-10) [dB]

L_{n,w} (C_i) 44 (4) [dB]

<https://www.klh.at/online-bauteilkatalog/>

THERMAL PROTECTION

U 0,19 [W/m²K]

m_{w,B,A} 31/109 [kg/m²]

MATERIAL

PROPERTIES

[mm]		λ [W/mK]	μ min-max [-]	ρ [kg/m³]	c [kJ/kgK]	
①	60.0 Cement screed	1.4	50	2200	1.1	A1
②	Separating layer					
③	30.0 Impact sound insulation s'≤ 30 MN/m³	0.036	1	70 - 150	0.84	A1
④	80.0 Polysterene fill	0.05	10	135	1.2	
⑤	Separating layer					
⑥	150.0 TL, KLH solid timber slab	0.12	50 - 300	470	1.6	D
⑦	60.0 Light weight C-profiles on resilient clips					A1
⑧	10.0 Air gap					
⑨	50.0 Mineral wool, low density	0.04	1	15-30	1	A1
⑩	12.5 Gypsum fiberboard	0.25	10	1000	1.1	A2
⑪	12.5 Gypsum fiberboard	0.25	10	1000	1.1	A2

Thickness 405,0 [mm]

Mass per squaremeter ca. 245 [kg/m²]

Test report sound: HFA 2592/2014-BB
Calculation of the physical values by the
KLH Massivholz GmbH, without warranty